

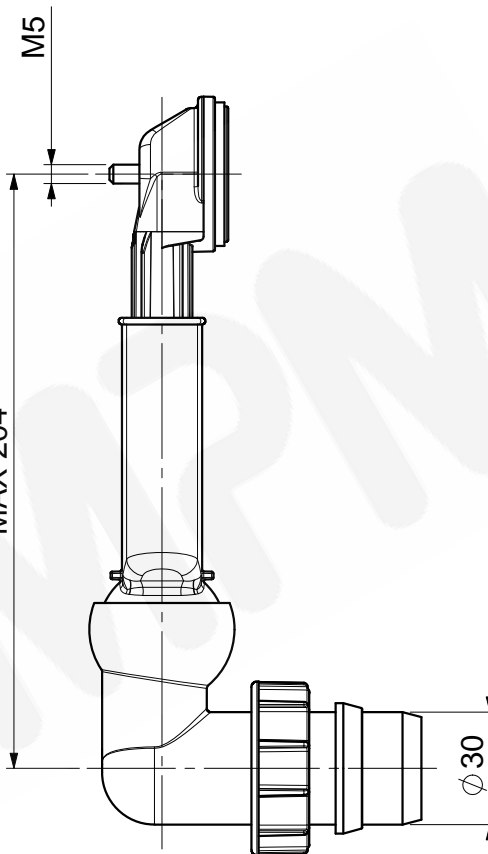

Ø 35,8

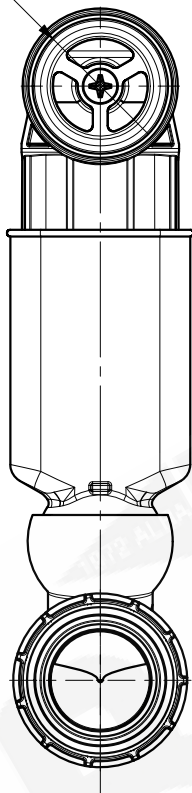

 engineering for plastic Via Monticella, 14 Rodengo Saiano (BS) 25050 ITALY tel. +390306811045 info@alba2.com www.alba2.com	Commercial Code <b>OVF30</b>
	001 Troppopieno tondo sezione ovale con snodo e griglietta
	002 Round overflow oval section with articulated joint and grille
	003 Runder Überlauf mit ovalem Querschnitt mit Gelenk und Überlaufsieb
<small>A termine di legge ci riserviamo la proprietà di questo disegno con divieto di riprodurlo o renderlo comunque noto a terzi senza nostra autorizzazione scritta. In compliance with the law we reserve ourselves the property of this drawing and prohibit its reproduction and/or release to third parties without our authorisation. ALBA2MPM S.p.A. si riserva il diritto di variare modelli e ingobri senza preavviso. ALBA2MPM S.p.A. reserves the right to alter design and specifications without notice.</small>	